

4.3

NAVIGUER *en mode* LOFT

The logo for Bali Catamarans features the word "BALI" in a large, bold, white sans-serif font. Above the letters "A" and "L" is a thin, curved line in a reddish-pink color. Below "BALI" is the word "CATAMARANS" in a smaller, white, all-caps sans-serif font.

BALI
CATAMARANS

LOFT (NM) : SE DIT LOFT, UN CONCEPT ARCHITECTURAL RECHERCHÉ QUI PERMET DE CONSTITUER DES ESPACES ENTIÈREMENT OUVERTS ET D'OBTENIR UNE SENSATION DE PLÉNITUDE ET DE LIBERTÉ.

LOFT: A SOUGHT-AFTER ARCHITECTURAL CONCEPT WHICH ALLOWS ENTIRELY OPEN SPACES TO BE COMBINED TO GIVE A SENSE OF FULLNESS AND FREEDOM.



BALI 4.3
L O F T



BALI 4.3 LOFT - FLYBRIDGE



PLATE FORME CENTRALE FERMÉE
CENTRAL PLATFORM CLOSED WITH GLASS DOOR COMPLETELY RETRACTABLE

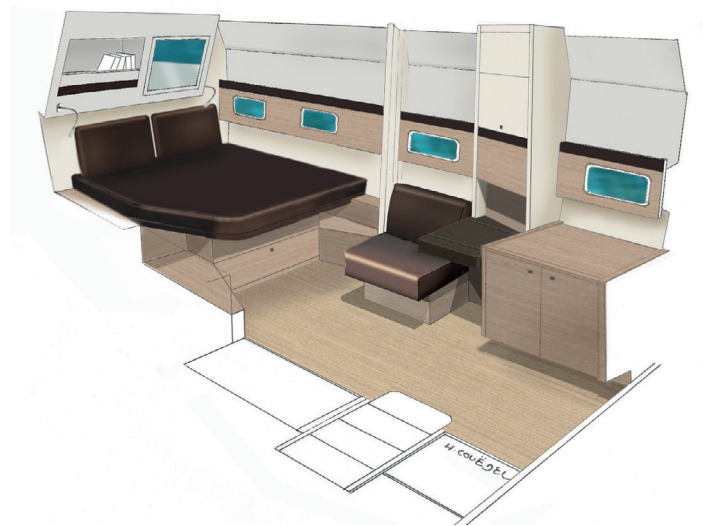

CABINE PROPRIÉTAIRE
OWNER'S CABIN

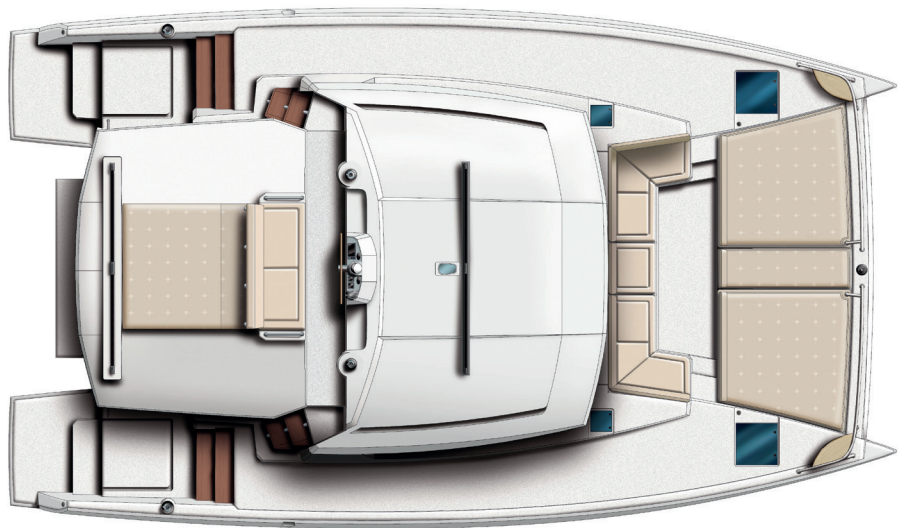

PLAN DE PONT
SHIPDECK

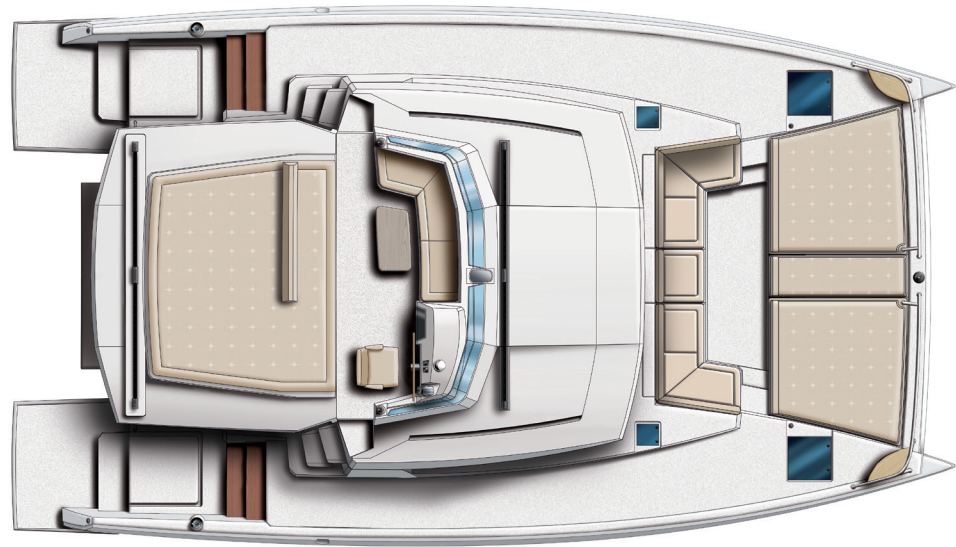

PLAN DE PONT N°2
SHIPDECK

BALI 4.3 CARACTÉRISTIQUES TECHNIQUES / SPECIFICATION

Conception	Olivier PONCIN	Longueur de flottaison / <i>Waterline length</i>	12,60 m / 41.4 ft	Surface de GV / <i>Mainsail area</i>	54,6 m ² / 587.7 sq ft
Architecte Naval / <i>Naval Architect</i>	Xavier FAÏ	Tirant d'eau / <i>Draft</i>	1,20 m / 3.93 ft	Solent / <i>Solent</i>	37,5 m ² / 403 sq ft
Design intérieur / <i>Design</i>	Hervé COUEDEL	Déplacement léger / <i>Light displacement</i>	10,2 t	Eau douce / <i>Fresh water</i>	800 l / 221 us gal
Longueur hors tout / <i>Overall length</i>	13,10 m / 43 ft	Déplacement en charge maxi / <i>maximum displacement</i>	14,25 t	Fuel	800 l / 221 us gal
Largeur / <i>Beam</i>	7,12 m / 23.35 ft	Surface de voile / <i>Sail area</i>	93,9 m ² / 1011 sq ft	Motorisation / <i>Engines</i>	2 x 40 cv / 2 x 50 hp
				CE CAT : A - 12 persons	 Made in France



Version 2 cabines - 2 sdb
2 cabin version - 2 bath.



Version 3 cabines - 2 sdb
3 cabin version - 2 bath.

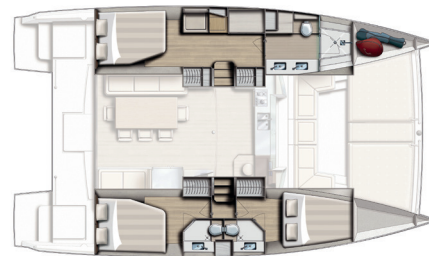

Version 3 cabines - 3 sdb
3 cabin version - 3 bath.

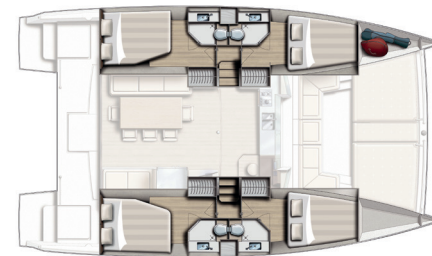

Version 4 cabines - 4 sdb
4 cabin version - 4 bath.



BALI CATAMARANS - Chantier Catana

Zone technique du Port - 66140 Canet en Roussillon - France - contact@bali-catamarans.com - www.bali-catamarans.com

CATANA Group



BALI

C A T A M A R A N S

Au-delà des conventions